

JIS B 2407 백업링

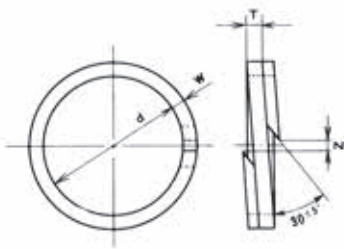

스파이럴

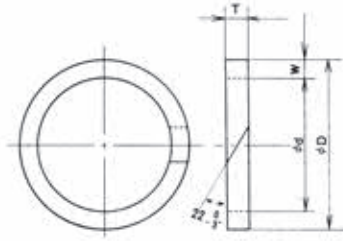

바이어스컷

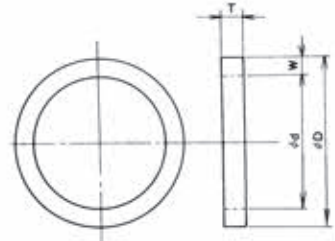

엔드리스

KNS 부품 번호			백업링 호칭번호	스파이럴(테프론)				바이어스컷 및 엔드리스(테프론)				적용링 JISB2401 호칭 번호	
T1(스파이럴)	T2(바이어스컷)	T3(엔드리스)		내경 d	폭 W	두께 T	틈새 Z	내경 d		외경 D	두께 T		
GN0090AO	GN0367AO	GN0711AO	P3	3	1.5 ^{+0.03} _{-0.05}	0.7 ^{±0.05}	1.2 ^{±0.4}	3	+0.15	6	0	1.25 ^{±0.1}	P3
GN0093AO	GN0370AO	GN0714AO	P4	4				4		7			P4
GN0095AO	GN0372AO	GN0716AO	P5	5				5		8			P5
GN0097AO	GN0375AO	GN0719AO	P6	6				6		9			P6
GN0099AO	GN0378AO	GN0722AO	P7	7				7		10			P7
GN0101AO	GN0380AO	GN0724AO	P8	8				8		11			P8
GN0102AO	GN0382AO	GN0727AO	P9	9				9		12			P9
GN0105AO	GN0386AO	GN0731AO	P10	10	10	13	P10						
GN0106AO	GN0387AO	GN0732AO	P10A	10	2.0 ^{+0.03} _{-0.05}	0.7 ^{±0.05}	1.4 ^{±0.8}	10	+0.15	14	0	1.25 ^{±0.1}	P10A
GN0107AO	GN0389AO	GN0734AO	P11	11				11		15			P11
GN0109AO	GN0390AO	GN0735AO	P11.2	11.2				11.2		15.2			P11.2
GN0110AO	GN0393AO	GN0739AO	P12	12				12		16			P12
GN0111AO	GN0395AO	GN0740AO	P12.5	12.5				12.5		16.5			P12.5
GN0113AO	GN0398AO	GN0744AO	P14	14				14		18			P14
GN0115AO	GN0401AO	GN0748AO	P15	15	15	19	P15						
GN0117AO	GN0402AO	GN0750AO	P16	16	16	20	P16						
GN0119AO	GN0408AO	GN0756AO	P18	18	18	22	P18						
GN0122AO	GN0413AO	GN0761AO	P20	20	20	24	P20						
GN0124AO	GN0414AO	GN0763AO	P21	21	21	25	P21						
GN0125AO	GN0418AO	GN0768AO	P22	22	22	26	P22						
GN0126AO	GN0419AO	GN0769AO	P22A	22	3.0 ^{+0.03} _{-0.05}	0.7 ^{±0.05}	2.5 ^{±1.5}	22	+0.20	28	0	1.25 ^{±0.1}	P22A
GN0128AO	GN0420AO	GN0770AO	P22.4	22.4				22.4		28.4			P22.4
GN0130AO	GN0425AO	GN0775AO	P24	24				24		30			P24
GN0132AO	GN0430AO	GN0780AO	P25	25				25		31			P25
GN0134AO	GN0431AO	GN0782AO	P25.5	25.5				25.5		31.5			P25.5
GN0135AO	GN0435AO	GN0786AO	P26	26				26		32			P26
GN0137AO	GN0439AO	GN0790AO	P28	28	28	34	P28						
GN0139AO	GN0441AO	GN0793AO	P29	29	29	35	P29						
GN0140AO	GN0444AO	GN0796AO	P29.5	29.5	29.5	35.5	P29.5						
GN0142AO	GN0446AO	GN0798AO	P30	30	30	36	P30						
GN0144AO	GN0451AO	GN0803AO	P31	31	3.0 ^{+0.03} _{-0.05}	0.7 ^{±0.05}	2.5 ^{±1.5}	31	+0.20	37	0	1.25 ^{±0.1}	P31
GN0145AO	GN0452AO	GN0804AO	P31.5	31.5				31.5		37.5			P31.5
GN0147AO	GN0453AO	GN0806AO	P32	32				32		38			P32
GN0149AO	GN0460AO	GN0813AO	P34	34				34		40			P34
GN0152AO	GN0462AO	GN0815AO	P35	35				35		41			P35
GN0153AO	GN0465AO	GN0819AO	P35.5	35.5	35.5	41.5	P35.5						
GN0154AO	GN0467AO	GN0822AO	P36	36	36	42	P36						
GN0156AO	GN0470AO	GN0825AO	P38	38	38	44	P38						
GN0159AO	GN0475AO	GN0829AO	P39	39	39	45	P39						
GN0160AO	GN0477AO	GN0831AO	P40	40	40	46	P40						
GN0161AO	GN0479AO	GN0834AO	P41	41	41	47	P41						
GN0164AO	GN0483AO	GN0839AO	P42	42	42	48	P42						
GN0165AO	GN0485AO	GN0841AO	P44	44	44	50	P44						
GN0169AO	GN0489AO	GN0844AO	P45	45	45	51	P45						
GN0170AO	GN0492AO	GN0848AO	P46	46	46	52	P46						

백업 링의 종류

종류기호	재료별	형 상
T1	테프론	스파이럴
T2	테프론	바이어스 컷
T3	테프론	엔드리스

KNS 부품 번호			백업링 호칭번호	스파이럴(테프론)				바이어스컷 및 엔드리스(테프론)				적용링 JISB2401 호칭 번호	
T1(스파이럴)	T2(바이어스컷)	T3(엔드리스)		내경 d	폭 W	두께 T	틈새 Z	내경 d		외경 D			두께 T
GN0173AO GN0175AO GN0177AO	GN0495AO GN0499AO GN0502AO	GN0851AO GN0856AO GN0859AO	P48 P49 P50	48 49 50	3.0 ^{+0.03} -0.05	0.7 ^{±0.05}	2.5 ^{±1.5}	48 49 50	+2.0 0	54 55 56	0 -0.20	1.25 ^{±0.1}	P48 P49 P50
GN0174AO GN0178AO	GN0496AO GN0503AO	GN0852AO GN0860AO	P48A P50A	48 50				48 50		58 60			P48A P50A
GN0180AO GN0181AO GN0185AO GN0186AO GN0189AO	GN0507AO GN0509AO GN0515AO GN0516AO GN0521AO	GN0866AO GN0868AO GN0874AO GN0876AO GN0882AO	P52 P53 P55 P56 P58	52 53 55 56 58				52 53 55 56 58		62 63 65 66 68			P52 P53 P55 P56 P58
GN0191AO GN0194AO GN0195AO GN0199AO GN0202AO	GN0524AO GN0529AO GN0531AO GN0536AO GN0540AO	GN0885AO GN0890AO GN0892AO GN0898AO GN0903AO	P60 P62 P63 P65 P67	60 62 63 65 67				60 62 63 65 67		70 72 73 75 77			P60 P62 P63 P65 P67
GN0206AO GN0207AO GN0211AO GN0216AO GN0220AO	GN0545AO GN0548AO GN0553AO GN0559AO GN0563AO	GN0909AO GN0913AO GN0919AO GN0926AO GN0931AO	P70 P71 P75 P80 P85	70 71 75 80 85	5.0 ^{+0.03} -0.05	0.9 ^{±0.06}	4.5 ^{±1.5}	70 71 75 80 85	+0.25 0	80 81 85 90 95	0 -0.25	1.9 ^{±0.13}	P70 P71 P75 P80 P85
GN0226AO GN0230AO GN0236AO GN0239AO GN0243AO	GN0569AO GN0573AO GN0579AO GN0581AO GN0585AO	GN0938AO GN0944AO GN0951AO GN0954AO GN0958AO	P90 P95 P100 P102 P105	90 95 100 102 105				90 95 100 102 105		100 105 110 112 115			P90 P95 P100 P102 P105
GN0246AO GN0249AO GN0254AO GN0258AO GN0262AO	GN0590AO GN0593AO GN0596AO GN0602AO GN0605AO	GN0965AO GN0969AO GN0973AO GN0981AO GN0985AO	P110 P112 P115 P120 P125	110 112 115 120 125				110 112 115 120 125		120 122 125 130 135			P110 P112 P115 P120 P125
GN0265AO GN0267AO GN0270AO GN0274AO GN0277AO	GN0609AO GN0611AO GN0614AO GN0617AO GN0621AO	GN0990AO GN0993AO GN0997AO GN1001AO GN1006AO	P130 P132 P135 P140 P145	130 132 135 140 145				130 132 135 140 145		140 142 145 150 155			P130 P132 P135 P140 P145
GN0280A1	GN0623AO	GN1009A2	P150	150				150		160			P150
GN0281AO GN0284AO GN0287AO GN0289AO GN0292AO	GN0624AO GN0628AO GN0631AO GN0633AO GN0636AO	GN1010AO GN1015AO GN1019AO GN1022AO GN1026AO	P150A P155 P160 P165 P170	150 155 160 165 170	7.5 ^{+0.03} -0.05	1.4 ^{±0.08}	6.0 ^{±2.0}	165 155 160 165 165 170	+0.30 0	165 170 175 180 185	0 -0.30	2.75 ^{±0.15}	P150A P155 P160 P165 P165 P170
GN0295AO GN0298AO GN0301AO GN0303AO GN0306AO	GN0639AO GN0642AO GN0645AO GN0647AO GN0650AO	GN1030AO GN1034AO GN1038AO GN1041AO GN1045AO	P175 P180 P185 P190 P195	175 180 185 190 195				175 180 185 190 195		190 195 200 205 210			P175 P180 P185 P190 P195

JIS B 2407 백업링

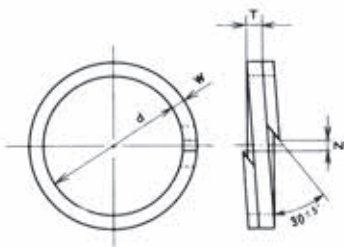

스파이럴

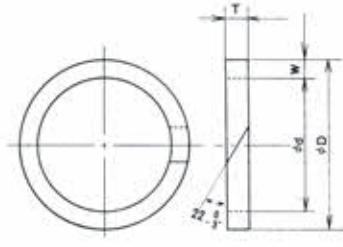

바이어스컷

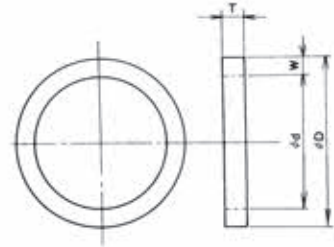

엔드리스

KNS 부품 번호			백업링 호칭번호	스파이럴(테프론)				바이어스컷 및 엔드리스(테프론)				적용오링 JISB2401 호칭 번호	
T1(스파이럴)	T2(바이어스컷)	T3(엔드리스)		내경 d	폭 W	두께 T	틈새 Z	내경 d		외경 D			두께 T
GN0309AO	GN0653AO	GN1049AO	P200	200				200		215			P200
GN0311AO	GN0655AO	GN1052AO	P205	205				205		220			P205
GN0312AO	GN0656AO	GN1054AO	P209	209				209		224			P209
GN0314AO	GN0658AO	GN1056AO	P210	210				210		225			P210
GN0315AO	GN0659AO	GN1059AO	P215	215				215		230			P215
GN0318AO	GN0662AO	GN1062AO	P220	220				220		235			P220
GN0319AO	GN0663AO	GN1064AO	P225	225				225		240			P225
GN0322AO	GN0666AO	GN1068AO	P230	230				230		245			P230
GN0323AO	GN0667AO	GN1070AO	P235	235				235		250			P235
GN0325AO	GN0669AO	GN1072AO	P240	240				240		255			P240
GN0327AO	GN0671AO	GN1075AO	P245	245				245		260			P245
GN0329AO	GN0673AO	GN1077AO	P250	250				250		265			P250
GN0331AO	GN0675AO	GN1080AO	P255	255				255		270			P255
GN0333AO	GN0677AO	GN1082AO	P260	260				260		275			P260
GN0334AO	GN0678AO	GN1084AO	P265	265	7.5 ^{+0.03} -0.05	1.4 ^{±0.08}	6.0 ^{±2.0}	265	+0.30 0	280	0 -0.30	2.75 ^{±0.15}	P265
GN0337AO	GN0681AO	GN1088AO	P270	270				270		285			P270
GN0338AO	GN0682AO	GN1090AO	P275	275				275		290			P275
GN0341AO	GN0684AO	GN1092AO	P280	280				280		295			P280
GN0342AO	GN0686AO	GN1095AO	P285	285				285		300			P285
GN0344AO	GN0688AO	GN1097AO	P290	290			290		305			P290	
GN0346AO	GN0690AO	GN1100AO	P295	295			295		310			P295	
GN0348AO	GN0692AO	GN1102AO	P300	300			300		315			P300	
GN0350AO	GN0694AO	GN1106AO	P315	315			315		330			P315	
GN0352AO	GN0696AO	GN1108AO	P320	320			320		335			P320	
GN0354AO	GN0698AO	GN1112AO	P335	335			335		350			P335	
GN0355AO	GN0699AO	GN1113AO	P340	340			340		355			P340	
GN0357AO	GN0701AO	GN1117AO	P355	355			355		370			P355	
GN0359AO	GN0703AO	GN1119AO	P360	360			360		375			P360	
GN0361AO	GN0705AO	GN1123AO	P375	375			375		390			P375	
GN0363AO	GN0707AO	GN1126AO	P385	385			385		400			P385	
GN0365AO	GN0709AO	GN1129AO	P400	400			400		415			P400	

백업 링의 종류

종류기호	재료별	형 상
T1	테프론	스파이럴
T2	테프론	바이어스 컷
T3	테프론	엔드리스

KNS 부품 번호			백업링 호칭번호	스파이럴(테프론)				바이어스컷 및 엔드리스(테프론)				적용링 JISB2401 호칭 번호	
T1(스파이럴)	T2(바이어스컷)	T3(엔드리스)		내경 d	폭 W	두께 T	틈새 Z	내경 d		외경 D	두께 T		
GN0131AO	GN0429AO	GN0779AO	G25	25				2.5		30			G25
GN0141AO	GN0445AO	GN0797AO	G30	30				30		35			G30
GN0151AO	GN0461AO	GN0814AO	G35	35				35		40			G35
GN1131AO	GN0476AO	GN0830AO	G40	40				40	+0.20	45	0		G40
GN0168AO	GN0488AO	GN0843AO	G45	45				45	0	50	-0.20		G45
GN0176AO	GN0501AO	GN0858AO	G50	50				50		55			G50
GN0184AO	GN0514AO	GN0873AO	G55	55				55		60			G55
GN0190AO	GN0523AO	GN0884AO	G60	60				60		65			G60
GN0198AO	GN0535AO	GN0897AO	G65	65				65		70			G65
GN0205AO	GN0543AO	GN0907AO	G70	70				70		75			G70
GN0210AO	GN0552AO	GN0918AO	G75	75				75		80			G75
GN0215AO	GN0558AO	GN0925AO	G80	80				80	+0.25	85	0		G80
GN0219AO	GN0562AO	GN0930AO	G85	85				85	0	90	-0.25	1.25±0.10	G85
GN0225AO	GN0568AO	GN0937AO	G90	90				90		95			G90
GN0229AO	GN0572AO	GN0943AO	G95	95				95		100			G95
GN0235AO	GN0578AO	GN0950AO	G100	100				100		105			G100
GN0242AO	GN0584AO	GN0957AO	G105	105				105		110			G105
GN0245AO	GN0589AO	GN0964AO	G110	110				110		115			G110
GN0253AO	GN0595AO	GN0972AO	G115	115				115		120			G115
GN0257AO	GN0601AO	GN0980AO	G120	120				120		125			G120
GN0261AO	GN0604AO	GN0984AO	G125	125				125		130			G125
GN0264AO	GN0608AO	GN0989AO	G130	130				130		135			G130
GN0269AO	GN0613AO	GN0996AO	G135	135				135		140			G135
GN0273AO	GN0616AO	GN1000AO	G140	140				140		145			G140
GN0276AO	GN0620AO	GN1005AO	G145	145				145		150			G145
GN0280A2	GN0623A2	GN1009A3	G150	150				150		160			G150
GN0283AO	GN0627AO	GN1014AO	G155	155				155		165			G155
GN0286AO	GN0630AO	GN1018AO	G160	160				160		170			G160
GN0288AO	GN0632AO	GN1021AO	G165	165				165		175			G165
GN0291AO	GN0635AO	GN1025AO	G170	170				170		180			G170
GN0294AO	GN0638AO	GN1029AO	G175	175				175		185			G175
GN0297AO	GN0641AO	GN1033AO	G180	180				180		190			G180
GN0300AO	GN0644AO	GN1037AO	G185	185				185		195			G185
GN0302AO	GN0646AO	GN1040AO	G190	190				190		200			G190
GN0305AO	GN0649AO	GN1044AO	G195	195				195		205			G195
GN0308AO	GN0652AO	GN1048AO	G200	200	5.0 ^{+0.03} -0.05	0.9±0.06	6.0±2.0	200	+0.30	210	0	1.9±0.13	G200
GN0313AO	GN0657AO	GN1055AO	G210	210				210	0	220	-0.30		G210
GN0317AO	GN0661AO	GN1061AO	G220	220				220		230			G220
GN0321AO	GN0665AO	GN1067AO	G230	230				230		240			G230
GN0324AO	GN0668AO	GN1071AO	G240	240				240		250			G240
GN0328AO	GN0672AO	GN1076AO	G250	250				250		260			G250
GN0332AO	GN0676AO	GN1081AO	G260	260				260		270			G260
GN0336AO	GN0680AO	GN1087AO	G270	270				270		280			G270
GN0340AO	GN0683AO	GN1091AO	G280	280				280		290			G280
GN0343AO	GN0687AO	GN1096AO	G290	290				290		300			G290
GN0347AO	GN0691AO	GN1101AO	G300	300				300		310			G300